



Energy efficient air curtain combined with a heat pump

Air curtains are designed to hang above an entrance and create a “thermal curtain” to separate the outside air from the cooled or heated indoor air. This can be done in a very energy-efficient manner in combination with a DX heat pump.

The EASYAIR DX air curtains are available as a free-hanging, cassette and recessed model. When installed in the ceiling, only the exhaust grid is visible.

When entering the room, the visitor immediately experiences a comfortable temperature. An additional advantage is that insects are kept out and that unpleasant odors are prevented.

The EASYAIR DX air curtain is suitable for an installation height up to 3.20 meters and is available in widths from 1.0 to 2.5 meters. The units have an operating range from -27 °C to +52 °C.

Can be used in (e.g.) shops, offices and public buildings.

Characteristics:

- Very energy efficient
- Low operating costs
- Intelligent control
- Easy operation
- Maximum comfort
- Easy installation



TYPE M/L

Lengths A (mm)

- 1.000
- 1.500
- 2.000
- 2.500

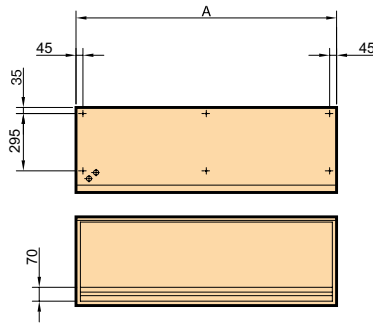
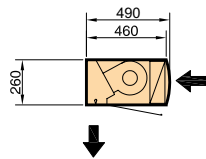

CASSETTE UNIT
TYPE M/L

Lengths A (mm)

- 1.000
- 1.500
- 2.000
- 2.500

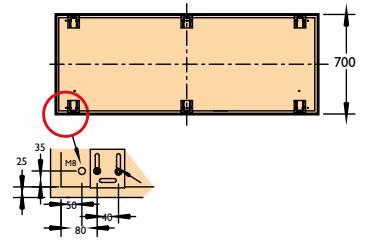
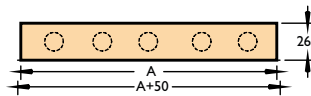
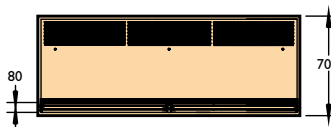
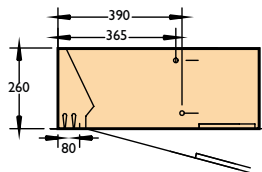
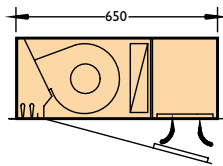

RECESSED MODEL
TYPE M/L

Lengths A (mm)

- 1.000
- 1.500
- 2.000
- 2.500

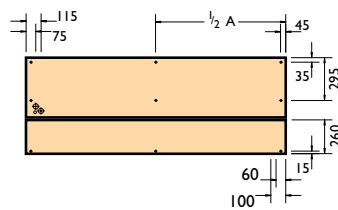
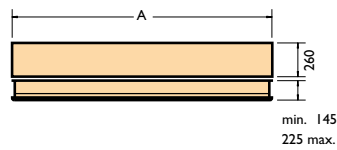
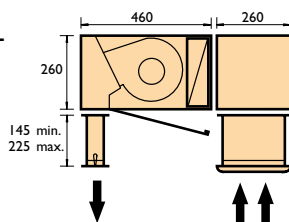

Technical information

Type		M1000	M1500	M2000	M2500	L1000	L1500	L2000	L2500
Heating capacity	kW	8,0	11,2	14,0	16,0	8,0	11,2	14,0	16,0
Air quantity	m ³ /h	1.600	2.400	3.200	4.000	2.210	2.950	4.420	5.160
Power consumption	kW	0,35	0,53	0,70	0,88	0,53	0,70	1,05	1,23
Door width	mm	1000	1500	2000	2500	1000	1500	2000	2500
Max. door height	mm	3000	3000	3000	3000	3200	3200	3200	3200
Sound power	dB(A)	54	55	56	57	55	56	57	58
Weight standard air curtain	kg	48	77	101	132	51	80	107	138
Weight air curtain cassette	kg	40	95	99	120	43	98	105	126
Weight recessed air curtain	kg	71	105	129	170	74	108	135	176
DI* outdoor unit	RAV-	GM801ATP	GM801ATP	GM1101ATP	GM1101ATP	GM1401ATP	GM1401ATP	-	-
SDI* outdoor unit	RAV-	GP801AT	GP801AT	GM1101AT	GM1101AT	GM1401AT	GM1401AT	GM1601AT8	GM1601AT8

* DI (Digital Inverter) heat pumps are suitable for cooling at temperatures up to +46°C and for heating at temperatures down to -20 ° C.
 SDI (Super Digital Inverter) heat pumps are suitable for cooling at temperatures up to +52°C and for heating at temperatures down to -27°C.
 For technical information, view page 174-177.

Assembly/location suggestions

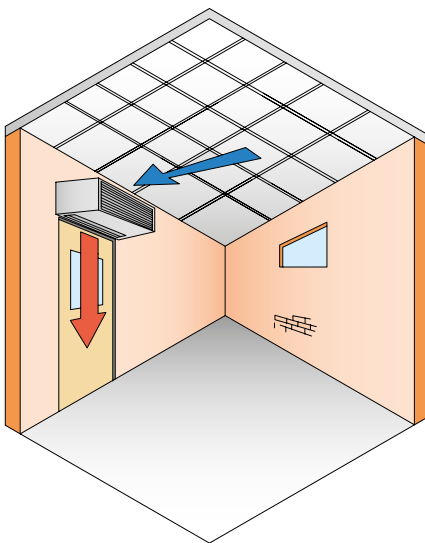

Prices Mark EASYAIR DX

PRODUCT - AIR CURTAIN EASYAIR DX - MAX. MOUNTING HEIGHT 3,2 M



Code nr.	Description	Price
5992500	Easyair DX M1000 with DI* heat pump, Heating capacity 8 kW	€ 12582
5992501	Easyair DX M1500 with DI* heat pump, Heating capacity 11,2 kW	€ 15350
5992502	Easyair DX M2000 with DI* heat pump, Heating capacity 14,0 kW	€ 17467
5992505	Easyair DX M1000 with SDI* heat pump, Heating capacity 8 kW	€ 13662
5992506	Easyair DX M1500 with SDI* heat pump, Heating capacity 11,2 kW	€ 16896
5992507	Easyair DX M2000 with SDI* heat pump, Heating capacity 14,0 kW	€ 19097
5992508	Easyair DX M2500 with SDI* heat pump, Heating capacity 16,0 kW	€ 21047
5992510	Easyair DX L1000 with DI* heat pump, Heating capacity 8 kW	€ 13250
5992511	Easyair DX L1500 with DI* heat pump, Heating capacity 11,2 kW	€ 15943
5992512	Easyair DX L2000 with DI* heat pump, Heating capacity 14,0 kW	€ 19270
5992515	Easyair DX L1000 with SDI* heat pump, Heating capacity 8 kW	€ 14331
5992516	Easyair DX L1500 with SDI* heat pump, Heating capacity 11,2 kW	€ 17489
5992517	Easyair DX L2000 with SDI* heat pump, Heating capacity 14,0 kW	€ 20900
5992518	Easyair DX L2500 with SDI* heat pump, Heating capacity 16,0 kW	€ 22613

PRODUCT - AIR CURTAIN EASYAIR DX CASSETTE UNIT - MAX. MOUNTING HEIGHT 3,2 M

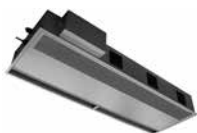

Code nr.	Description	Price
5992520	Easyair DX M1000 cassette unit with DI* heat pump, Heating capacity 8 kW	€ 13058
5992521	Easyair DX M1500 cassette unit with DI* heat pump, Heating capacity 11,2 kW	€ 15447
5992522	Easyair DX M2000 cassette unit with DI* heat pump, Heating capacity 14,0 kW	€ 17659
5992525	Easyair DX M1000 cassette unit with SDI* heat pump, nominal power 8 kW	€ 14137
5992526	Easyair DX M1500 cassette unit with SDI* heat pump, nominal power 11,2 kW	€ 16995
5992527	Easyair DX M2000 cassette unit with SDI* heat pump, nominal power 14,0 kW	€ 19289
5992528	Easyair DX M2500 cassette unit with SDI* heat pump, nominal power 16,0 kW	€ 21988
5992530	Easyair DX L1000 cassette unit with DI* heat pump, nominal power 8 kW	€ 13927
5992531	Easyair DX L1500 cassette unit with DI* heat pump, nominal power 11,2 kW	€ 16308
5992532	Easyair DX L2000 cassette unit with DI* heat pump, nominal power 14,0 kW	€ 19388
5992535	Easyair DX L1000 cassette unit with SDI* heat pump, nominal power 8 kW	€ 15008
5992536	Easyair DX L1500 cassette unit with SDI* heat pump, nominal power 11,2 kW	€ 17856
5992537	Easyair DX L2000 cassette unit with SDI* heat pump, nominal power 14,0 kW	€ 21018
5992538	Easyair DX L2500 cassette unit with SDI* heat pump, nominal power 16,0 kW	€ 23702

PRODUCT - AIR CURTAIN EASYAIR DX RECESSED MODEL - MAX. MOUNTING HEIGHT 3,2 M



Code nr.	Description	Price
5992550	Easyair DX M1000 recessed model with DI* heat pump, nominal power 8 kW	€ 13602
5992551	Easyair DX M1500 recessed model with DI* heat pump, nominal power 11,2 kW	€ 16625
5992552	Easyair DX M2000 recessed model with DI* heat pump, nominal power 14,0 kW	€ 18979
5992555	Easyair DX M1000 recessed model with SDI* heat pump, nominal power 8 kW	€ 14681
5992556	Easyair DX M1500 recessed model with SDI* heat pump, nominal power 11,2 kW	€ 18173
5992557	Easyair DX M2000 recessed model with SDI* heat pump, nominal power 14,0 kW	€ 20609
5992558	Easyair DX M2500 recessed model with SDI* heat pump, nominal power 16,0 kW	€ 22700
5992560	Easyair DX L1000 recessed model with DI* heat pump, nominal power 8 kW	€ 14276
5992561	Easyair DX L1500 recessed model with DI* heat pump, nominal power 11,2 kW	€ 17221
5992562	Easyair DX L2000 recessed model with DI* heat pump, nominal power 14,0 kW	€ 20401
5992565	Easyair DX L1000 recessed model with SDI* heat pump, nominal power 8 kW	€ 15355
5992566	Easyair DX L1500 recessed model with SDI* heat pump, nominal power 11,2 kW	€ 18769
5992567	Easyair DX L2000 recessed model with SDI* heat pump, nominal power 14,0 kW	€ 22031
5992568	Easyair DX L2500 recessed model with SDI* heat pump, nominal power 16,0 kW	€ 24257

* DI (Digital Inverter) heat pumps are suitable for cooling at temperatures up to +46°C and for heating at temperatures down to -20 ° C. SDI (Super Digital Inverter) heat pumps are suitable for cooling at temperatures up to +52°C and for heating at temperatures down to -27°C.